

APPLICATIONS

Betta Resilient seat gate valves comply with AS/NZS 2638.2 and are suitable for use in potable water, non-potable water and wastewater systems installed above ground and below ground.

The VGFB Series model with ISO flange is designed to be operated by a mounted gearbox actuator or manual actuator.

TECHNICAL DATA

Standard:	AS/NZS 2638.2 (Lic OMK25731) WSAA Product Appraisal 1121 – Betta Valves
Size Range:	DN 450 – DN 600
Pressures:	Operating Pressure 1600 kPa (PN 16) Test Pressure – Seal 1760 kPa Test Pressure – Body 2400 kPa
Temperatures:	Max 80 deg C, Max 40 deg C for potable water systems to AS 4020
Coating:	Fusion Bonded coating to AS/NZS 4158
End connections:	Flange (AS 4087, PN16)
Actuator Flange:	F16 ISO 5211 Flange
Bypass Valve:	Resilient Seat PN16 AS/NZS 2638.2 (VGF Series)
Closing options:	Anti-clockwise (ACC) and Clockwise closing (CC)
Options:	Handwheels or Gearbox actuators Extension spindles



FLANGE BYPASS PN16

DN 450 – 600

FEATURES

High strength and corrosion resistant materials
EPDM encapsulated ductile iron wedge ensures effective sealing
Full bore design eliminates blockages
Anti-friction components for lower operating torques
Integrated cast in foot design provides stability
Isolated fasteners are encapsulated with hot melt silicon coating
10 Year Manufacturer's Warranty against Defects.

COMPONENTS

ITEM	PART	MATERIAL	STANDARD
1	Body	Ductile Iron Gr 500-7	AS 1831
2	Wedge	Ductile Iron Gr 500-7, EPDM encapsulated	AS 1831 AS 1646
3	Stem Nut	Bronze C95210	AS 1565
4	Stem	Stainless Steel Gr 431	ASTM A276
5	Bonnet Gasket	EPDM	AS 1646
6	Bolts – Bonnet, Gland & Stem Cap	Stainless Steel Gr 316	ASTM A276
7	Bonnet	Ductile Iron Gr 500-7	AS 1831
8	Gland ISO Flange	Ductile Iron Gr 500-7	AS 1831
9	Stem Key	Stainless Steel	ASTM A276
10	Bushing	DR Brass C48600	AS 1568
11	O-Ring Seals	NBR	AS 1646
12	Bearing		
13	Gland O-Ring	NBR	AS 1646
14	Bushing	DR Brass C48600	AS 1568
15	Stem Seals	NBR	AS 1646
16	Dust Cover	EPDM	AS 1646
17	Stem Cap	Ductile Iron Gr 500-7	AS 1831
18	Eyebolt	Carbon Steel	Galv
19	Bypass Valve	Resilient Seat PN16 (VGF)	AS2638.2
20	Flange Bolt/Nuts	Stainless Steel Gr 316	ASTM A276
21	Bypass Bend	Ductile Iron Gr 500-7	AS 1831

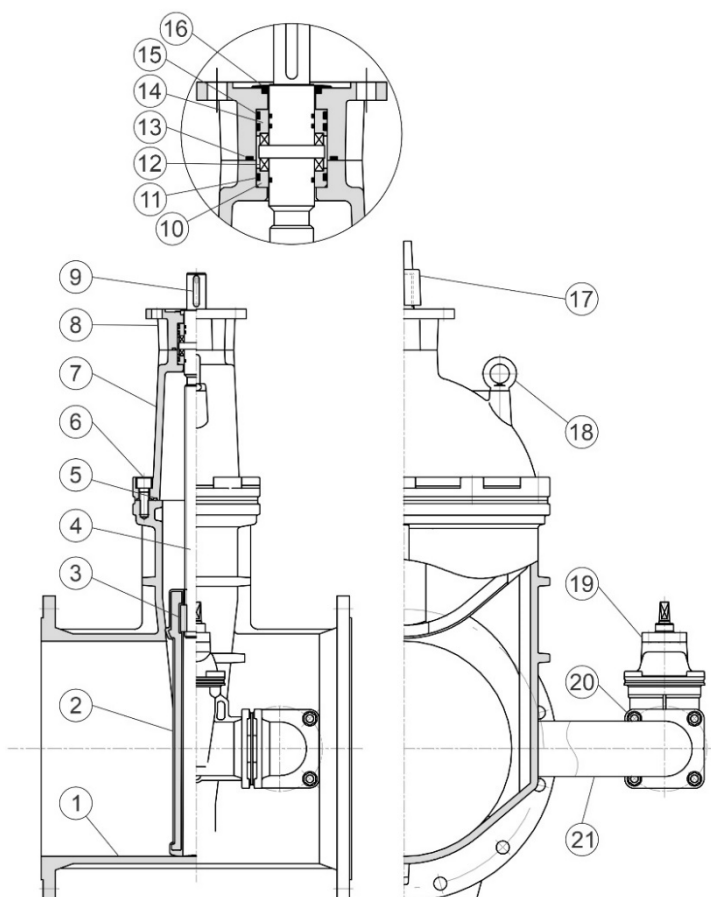

FLANGE BYPASS PN16

DN 450 – 600

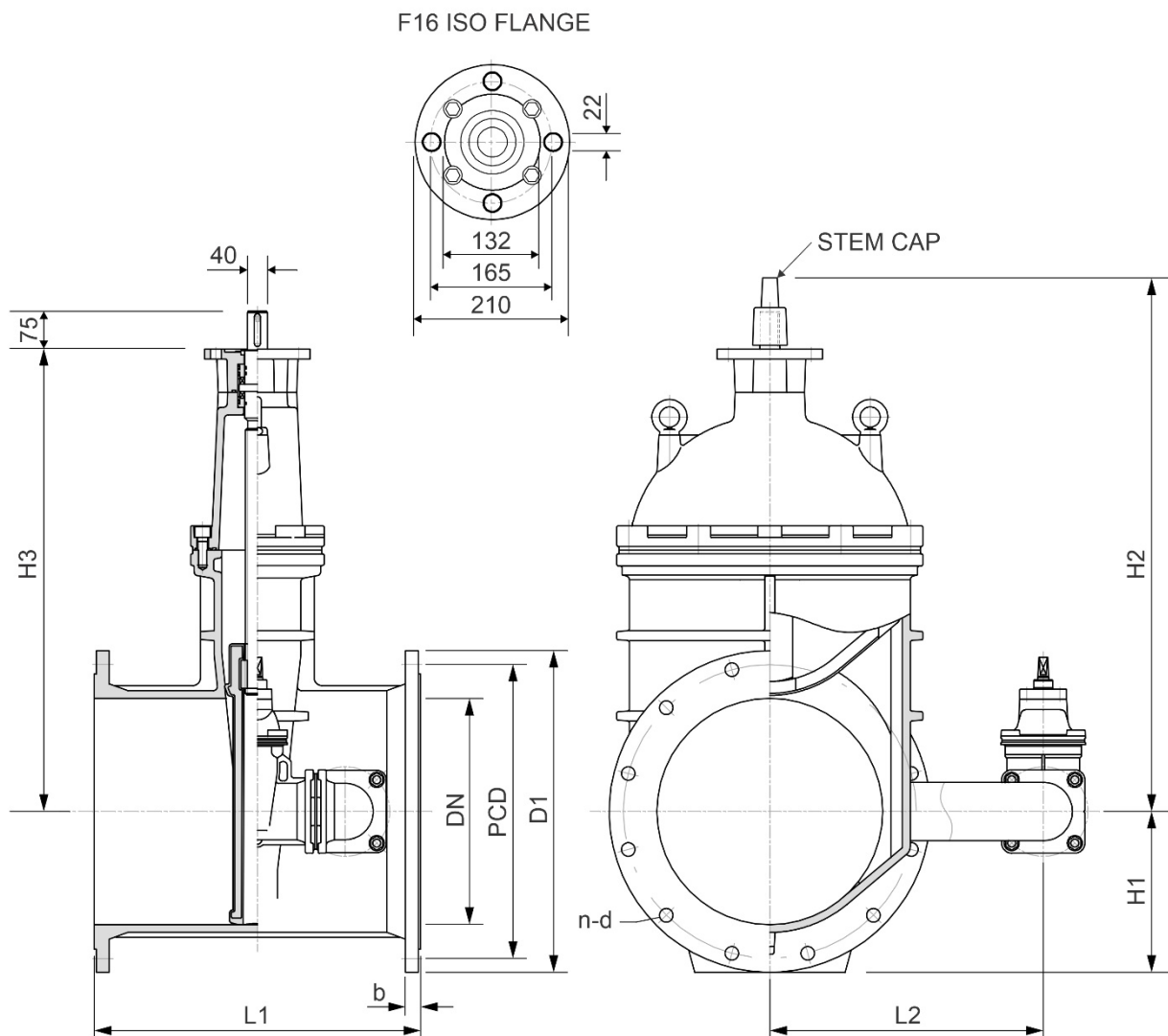

DIMENSIONS

DN	Bypass DN	L1	L2	H1	H2	H3	D1	PCD	n-d	b	No Turns	Torque In Nm	Weight kg	ACC	CC
450	100	650	555	320	1069	920	640	584	12-26d	33	58	420	395	VGFB4510	VGFB4510C
500	100	700	775	353	1160	1010	705	641	16-26d	35	64	500	510	VGFB5010	VGFB5010C
500	150	700	775	353	1160	1010	705	641	16-26d	35	64	500	510	VGFB5015	VGFB5015C
600	150	785	835	412.5	1334	1185	825	756	16-30d	42	68	535	780	VGFB6015	VGFB6015C

CIVILPIPES PTY LTD

ABN 30 168 566 667
2 Potassium St. Narangba Qld 4504
PO Box 304, North Lakes Qld 4509



Web:
civilpipes.com.au



Telephone:
+61 7 3053 3456



E-mail:
sales@civilpipes.com.au

