

FLANGE ISO MOUNT PN16

DN 350 – 400

APPLICATIONS

Betta Resilient seat gate valves comply with AS/NZS 2638.2 and are suitable for use in potable water, non-potable water and wastewater systems installed above ground and below ground.

The VGFI Series model with ISO flange is designed to be operated by a mounted gearbox actuator.

TECHNICAL DATA

Standard:	AS/NZS 2638.2 (Lic OMK25731) WSAA Product Appraisal 1121 – Betta Valves
Size Range:	DN 350 – DN 400
Pressures:	Operating Pressure 1600 kPa (PN 16) Test Pressure – Seal 1760 kPa Test Pressure – Body 2400 kPa
Temperatures:	Max 80 deg C, Max 40 deg C for potable water systems to AS 4020
Coating:	Fusion Bonded coating to AS/NZS 4158
End connections:	Flange (AS 4087, PN16)
Actuator Flange:	F16 ISO 5211 Flange (F14 option available on request)
Closing options:	Anti-clockwise (ACC) and Clockwise closing (CC)
Options:	Handwheels or Gearbox actuators Extension spindles Restraint – Anchor Legs and SS Straps Alternate Flange drillings available on request



FEATURES

High strength and corrosion resistant materials
EPDM encapsulated ductile iron wedge ensures effective sealing
Full bore design eliminates blockages
Anti-friction components for lower operating torques
Integrated cast in foot design provides stability
Isolated fasteners are encapsulated with hot melt silicon coating
Valve can be installed in either the vertical or horizontal position.
10 Year Manufacturer's Warranty against Defects.

COMPONENTS

ITEM	PART	MATERIAL	STANDARD
1	Body	Ductile Iron Gr 500-7	AS 1831
2	Wedge	Ductile Iron Gr 500-7, EPDM encapsulated	AS 1831 AS 1646
3	Stem Nut	Alum Bronze C95210	AS 1565
4	Stem	Stainless Steel Gr 431	ASTM A276
5	Body Bonnet Gasket	EPDM	AS 1646
6	Bolts – Bonnet, Gland & Stem Cap	Stainless Steel Gr 316	ASTM A276
7	Bonnet	Ductile Iron Gr 500-7	AS 1831
8	Gland ISO Flange	Stainless Steel Gr 316	ASTM A276
9	Stem Key	Stainless Steel	ASTM A276
10	Gland O-Ring	NBR	AS 1646
11	O-Ring Seals	NBR	AS 1646
12	Bushing	DR Brass C48600	AS 1568
13	Bushing	DR Brass C48600	AS 1568
14	Stem Seals	NBR	AS 1646
15	Dust Cover	EPDM	AS 1646
16	Eyebolt	Carbon Steel	Galv
17	Stem Cap	Ductile Iron Gr 500-7	AS 1831

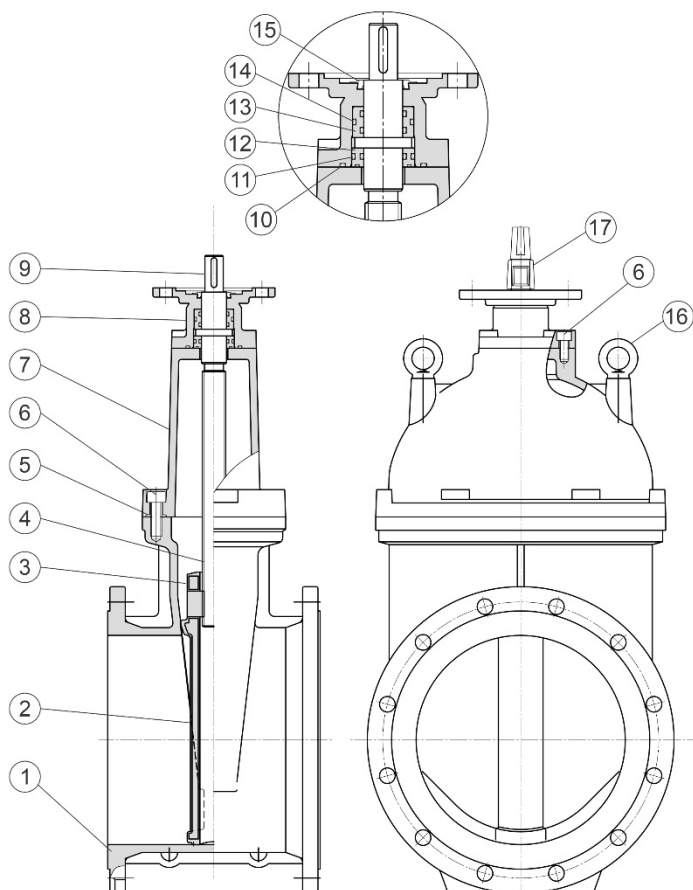

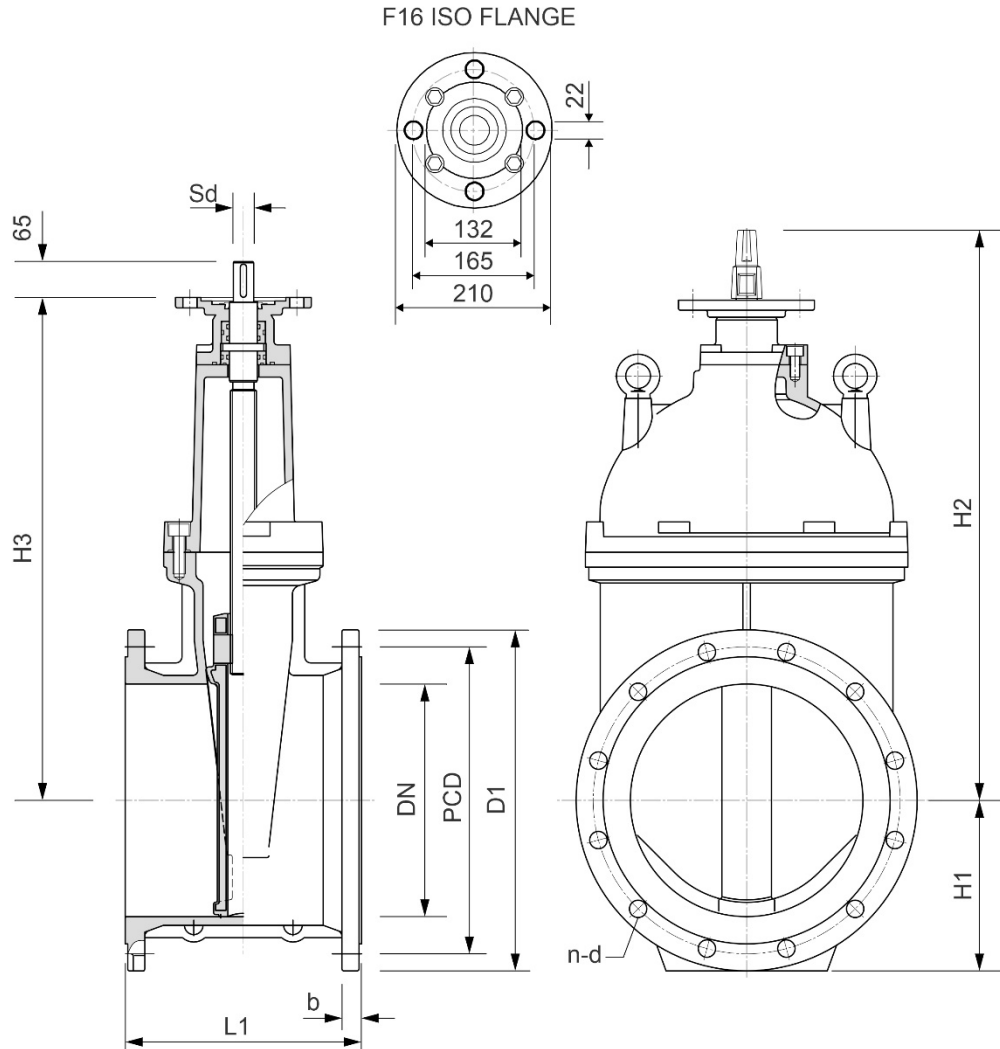

DIMENSIONS

DN	L1	H1	H2	H3	Sd	D1	PCD	n-d	b	No Turns	Torque In Nm	Weight kg	ACC	CC
350	381	263	935	810	40	525	470	12-26d	33	55	350	250	VGFI35	VGFI35C
375	381	275	935	810	40	550	495	12-26d	33	55	330	225	VGFI37	VGFI37C
400	406	290	1140	1015	40	580	521	12-26d	33	52	360	295	VGFI40	VGFI40C

CIVILPIPES PTY LTD

ABN 30 168 566 667
2 Potassium St. Narangba Qld 4504
PO Box 304, North Lakes Qld 4509



Web:
civilpipes.com.au



Telephone:
+61 7 3053 3456



E-mail:
sales@civilpipes.com.au

