

APPLICATIONS

WAGA Multi/Joint Flange Adaptors are suitable for use in potable water; non-potable water and wastewater pipelines.

The flange adaptor has full restraint capability and can join all rigid and flexible pipe materials.

Suitable for below ground and above ground applications.

TECHNICAL DATA

Size Range	DN 50 to DN 400
Working Pressure:	
- DN 50 to DN 300	PN16 (Water)
- DN 350 to DN 400	PN10 (Water)
Working Temperature	-5 to 50 deg C (Water)
Mechanical Joint	Full Restraint with Uni/Fiks Rings
Deflection	8 deg Max per end connection (based on middle of range)
Flanges	Drilled Table D to AS2129

Refer to [WAGA MULTI/JOINT 3000 Product Guide](#) for further technical data. Contact us or download from www.civilpipes.com.au.



FEATURES

The wide range sealing system makes this product ideal for joining PE, PVC-O, PVC-M, PVC-U, GRP, DI, CI, AC, and Steel pipelines.

Unique sealing system that comprises an EPDM seal with flexible ring (Uni/Fiks) that consists of plastic segments with stainless steel grippers to secure the pipe joint. With the Uni/Fiks ring, all joints can be made restraint as long as the nominal diameters are the same.

Corrosion resistant materials suitable for drinking water and wastewater applications.

Can be installed without disassembling which makes installation faster and easier.

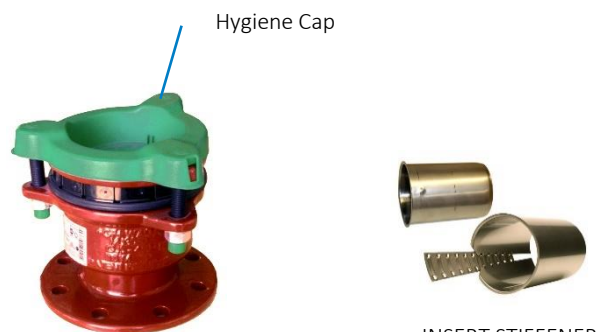
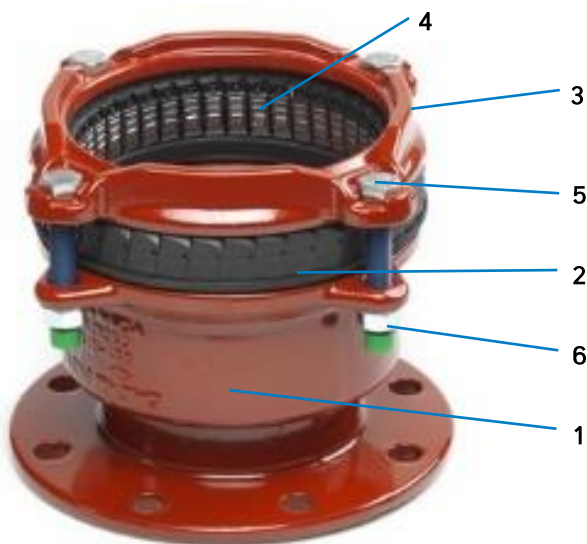

COMPONENTS

ITEM	PART	MATERIAL	STANDARD
1	Body	Ductile Iron GGG45 epoxy coated	EN-GJS-450-10, AS/NZS4158
2	Varioseal	EPDM	AS 681.1
3	Clamp Ring	Ductile Iron GGG45 epoxy coated	EN-GJS-450-10, AS/NZS4158
4	Uni/Fiks Ring - Plastic Ring	POM/Polyamide (Uni/Fleks)	
	- Metal Grippers	316 Stainless Steel (Uni/Fiksers)	AISI 316
5	Bolts	316 Stainless Steel, PTFE Coated	AISI 316
6	Nuts & Washers	316 Stainless Steel	AISI 316

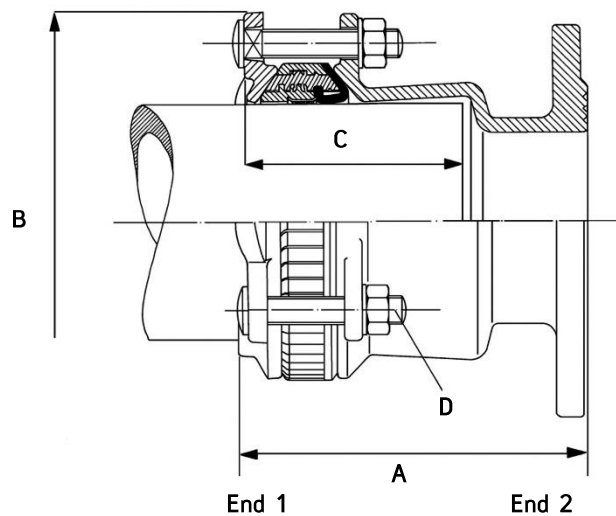
3057 RESTRAINT FLANGE ADAPTOR

Prod Code	Nom Dia	Size Range	Flange DN	Flange Drilling	Flange Bolt Holes	A	B	C	D	PN Water	Weight
	DN	End 1		End 2		mm	mm	mm		kPa	kg
DGWF050	50	46 - 71	50	T/D	4 - M16	179-194	164	100	3 - M12	1600	5.6
DGWF065	65	63 - 90	65	T/D	4 - M16	187-198	186	95	3 - M12	1600	6.5
DGWF080	80	84 - 105	80	T/D	4 - M16	183-197	204	115	3 - M12	1600	6.5
DGWF100	100	104 - 132	100	T/D	4 - M16	181-200	236	110	3 - M16	1600	8.6
DGWF125	125	132 - 155	125	T/D	8 - M16	196-214	264	120	4 - M16	1600	13.0
DGWF150	150	154 - 192	150	T/D	8 - M16	194-222	304	120	4 - M16	1600	14.0
DGWF200	200	192 - 232	200	T/D	8 - M16	224-251	354	140	6 - M16	1600	21.7
DGWF250	250	267 - 310	250	T/D	8 - M20	260-295	432	170	6 - M20	1600	31.1
DGWF300	300	315 - 356	300	T/D	12 - M20	283-318	490	170	8 - M20	1600	40.5
DGWF350	350	352 - 393	350	T/D	12 - M24	326-364	534	245	8 - M20	1000	52.1
DGWF400	400	392 - 433	400	T/D	12 - M24	356-395	574	275	10 - M20	1000	65.1

NOTES

Flanges: Drilled Table D to AS2129

Installation: Refer to the [GF WAGA MULTI/JOINT Installation Guide](#) for details of required pipe gap, minimum insertion dimensions, torque settings and general assembly instructions.

Refer to the [GF SS Insert Stiffener Guide](#) for details of when and why inserts are required.

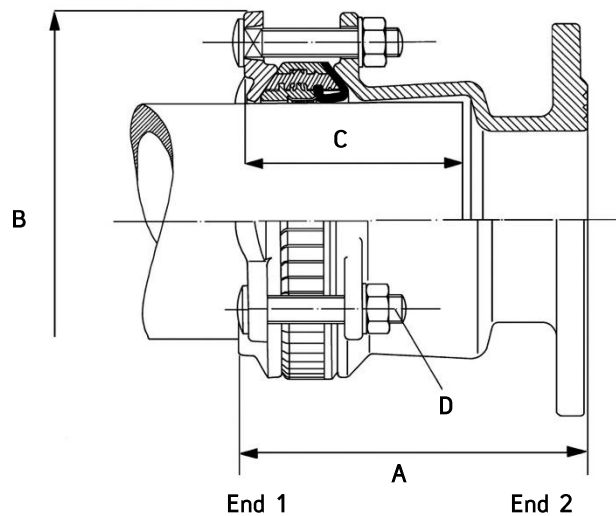
3157 RESTRAINT REDUCED FLANGE ADAPTOR

Prod Code	Nom Dia	Size Range	Flange DN	Flange Drilling	Flange Bolt Holes	A	B	C	D	PN Water	Weight
	DN - DN	End 1		End 2		mm	mm	mm		kPa	kg
DGWF050040	50 - 40	46 - 71	40	T/D	4 - M12	185-200	164	100	3-M12	1600	5.0
DGWF065080	65 - 80	63 - 90	80	T/D	4 - M16	198-210	186	95	3-M12	1600	6.7
DGWF100080	100 - 80	104 - 132	80	T/D	4 - M16	196-215	236	110	3-M16	1600	9.1
DGWF125100	125 - 100	132 - 155	100	T/D	4 - M16	197-215	264	120	4-M16	1600	11.8
DGWF125150	125 - 150	132 - 155	150	T/D	8 - M16	276-294	264	120	4-M16	1600	13.2
DGWF150100	150 - 100	154 - 192	100	T/D	4 - M16	200-228	304	120	4-M16	1600	13.3
DGWF200150	200 - 150	192 - 232	150	T/D	8 - M16	249-276	354	130	6-M16	1600	20.4
DGWF225200	225 - 200	230 - 268	200	T/D	8 - M16	274-301	386	190	6-M20	1600	29.7
DGWF225250	225 - 250	230 - 268	250	T/D	8 - M20	212-239	386	130	6-M20	1600	27.7
DGWF300250	300 - 250	315 - 356	250	T/D	8 - M20	320-355	490	155	8-M20	1600	38.3
DGWF350300	350 - 300	352 - 393	300	T/D	12 - M20	304-346	534	225	8-M20	1000	48.1

NOTES

Flanges: Drilled Table D to AS2129

Installation: Refer to the [GF WAGA MULTI/JOINT Installation Guide](#) for details of required pipe gap, minimum insertion dimensions, torque settings and general assembly instructions.

Refer to the [GF SS Insert Stiffener Guide](#) for details of when and why inserts are required.

CIVILPIPES PTY LTD

ABN 30 168 566 667
 2 Potassium St. Narangba Qld 4504
 PO Box 304, North Lakes Qld 4509

CONTACT

T: +61 7 3053 3456
 E: sales@civilpipes.com.au
 W: www.civilpipes.com.au

