

APPLICATIONS

Resilient seat gate valves comply with AS 2638.2 and are suitable for use in potable water, non-potable water and wastewater systems installed above ground and below ground.

TECHNICAL DATA

Standard:	AS 2638.2 (Lic OMK25731) WSAA Product Appraisal I121 Issue 8 – Betta Valves
Size Range:	DN 100 – DN 150
Pressures:	Operating Pressure 1600 kPa (PN 16) Test Pressure – Seal 1760 kPa Test Pressure – Body 2400 kPa
Temperatures:	Max 80 deg C, Max 40 deg C for potable water systems to AS 4020
Coating:	Fusion Bonded coating to AS/NZS 4158
End connections:	Spigot (AS/NZS 2280)
Closing options:	Anti-clockwise (ACC) and Clockwise closing (CC)
Options:	Handwheels or Gearbox actuators ISO flange for gearbox actuators Extension spindles



SPIGOT PN16
DN 100 – 150

FEATURES

High strength and corrosion resistant materials
EPDM encapsulated ductile iron wedge ensures effective sealing
Full bore design eliminates blockages
Anti-friction components for lower operating torques

COMPONENTS

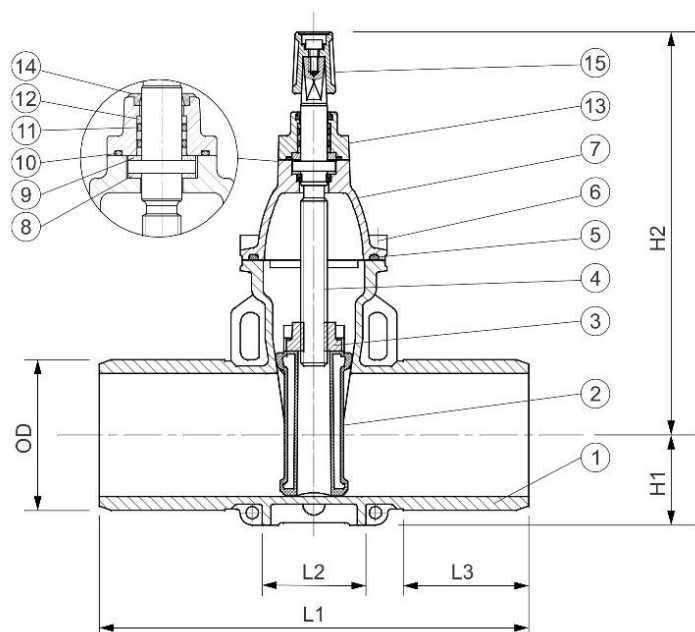

ITEM	PART	MATERIAL	STANDARD
1	Body	Ductile Iron Gr 500-7	AS 1831
2	Wedge	Ductile Iron Gr 500-7, EPDM encapsulated	AS 1831 AS 1646
3	Stem Nut	DR Brass C48600	AS 1568
4	Stem	Stainless Steel Gr 431	ASTM A276
5	Bonnet Gasket	EPDM	AS 1646
6	Bolts – Bonnet, Dust Cover & Stem Cap	Stainless Steel Gr 316	ASTM A276
7	Bonnet	Ductile Iron Gr 500-7	AS 1831
8	Washer	EPDM	AS 1646
9	Washer	DR Brass C48600	AS 1568
10	Bonnet O-Ring	NBR	AS 1646
11	O-Ring Seals	NBR	AS 1646
12	Thrust Collars	POM	AS 1646
13	Seal Retainer	DN80-150 – SS Gr 316 Other sizes – DI Gr 500-7	ASTM A276 AS 1831
14	Dust Cover	EPDM	AS 1646
15	Stem Cap	Ductile Iron Gr 500-7	AS 1831

DIMENSIONS

DN	OD	L1	L2	L3	H1	H2	No Turns	Torque In Nm	Weight kg	ACC	CC
100	122	345	80	102	90	340	22	60	17	VGP10	VGP10C
150	177	365	104	102	115	450	32	110	28	VGP15	VGP15C

CIVILPIPES PTY LTD

ABN 30 168 566 667
2 Potassium St. Narangba Qld 4504
PO Box 304, North Lakes Qld 4509



Web:
civilpipes.com.au



Telephone:
+61 7 3053 3456



E-mail:
sales@civilpipes.com.au

